



SPINNERS GATE

DOAGH ROAD | BALLYEARL | NEWTOWNABBEY



CGI shown for illustration purposes only

THE DAMASK

3 BEDROOM SEMI DETACHED HOME
TOTAL FLOOR AREA 1076 sq. ft. approx



GROUND FLOOR

Entrance Hall with separate WC

Lounge

ft 16'2" x 11'8" m 4.92 x 3.58

Kitchen / Dining

ft 19'2" x 10'9" m 5.83 x 3.30

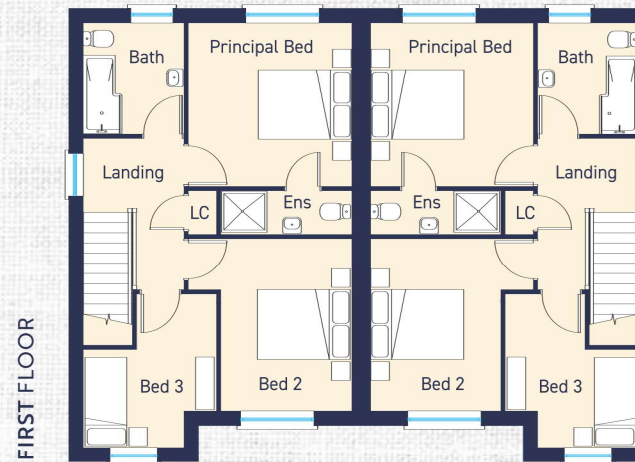

FIRST FLOOR

Principal Bedroom

ft 11'6" x 11'6" m 3.52 x 3.51

Ensuite

Bedroom 2

ft 12'2" x 9'3" m 3.70 x 2.81

Bedroom 3

ft 9'4" x 6'9" m 2.86 x 2.09

Bathroom

LU = Laundry Unit

LC = Linen Cupboard

The architectural 3d perspective is for illustration purposes only and as such the elevation shown may vary from the actual finish on site. All dimensions are approx.



Reeds Rains

Since 1868

T: 028 9084 3427

www.reedsrains.co.uk



www.vaughan-homes.com